



1 - THUJA PLICATA



2 - CHIONOCHLOA RUBRA. RED TUSSOCK



3 - CORDYLINAE AUSTRALIS (CABBAGE TREE)



4 - COLEONEMA 'SUNSET GOLD' (BREATH OF HEAVEN)



5 - LOMANDRA ECHIDNA



6 - PSEUDOPANAX CRASSIFOLIUS (LANCEWOOD)

**PLANTING SCHEDULE:**

- 1 - THUJA PLICATA
- 2 - CHIONOCHLOA RUBRA. RED TUSSOCK
- 3 - CORDYLINAE AUSTRALIS (CABBAGE TREE)
- 4 - COLEONEMA 'SUNSET GOLD' (BREATH OF HEAVEN)
- 5 - LOMANDRA ECHIDNA
- 6 - PSEUDOPANAX CRASSIFOLIUS (LANCEWOOD)

**PLANTING NOTES:**

- ALL TREES TO HAVE MIN 1.5 m HEIGHT AT TIME OF PLANTING
- ALL TREES TO HAVE 1 m<sup>3</sup> MEDIUM SOIL VOLUME
- UNDERPLANT WITH HEBE DECUMBENS HEBE ODURA PLANTS TO BE BARK CHIP FINISHED.
- LANDSCAPING TO BE MINIMUM 50% TREES AND SHRUBS.

**LANDSCAPING AREA:**

SHRUBS/TREES - 46 m<sup>2</sup> (10% or 50 m<sup>2</sup> REQUIRED)

SHRUBS AND ASSOCIATED LAWNS - 94 m<sup>2</sup> (20% or 101 m<sup>2</sup> REQUIRED)

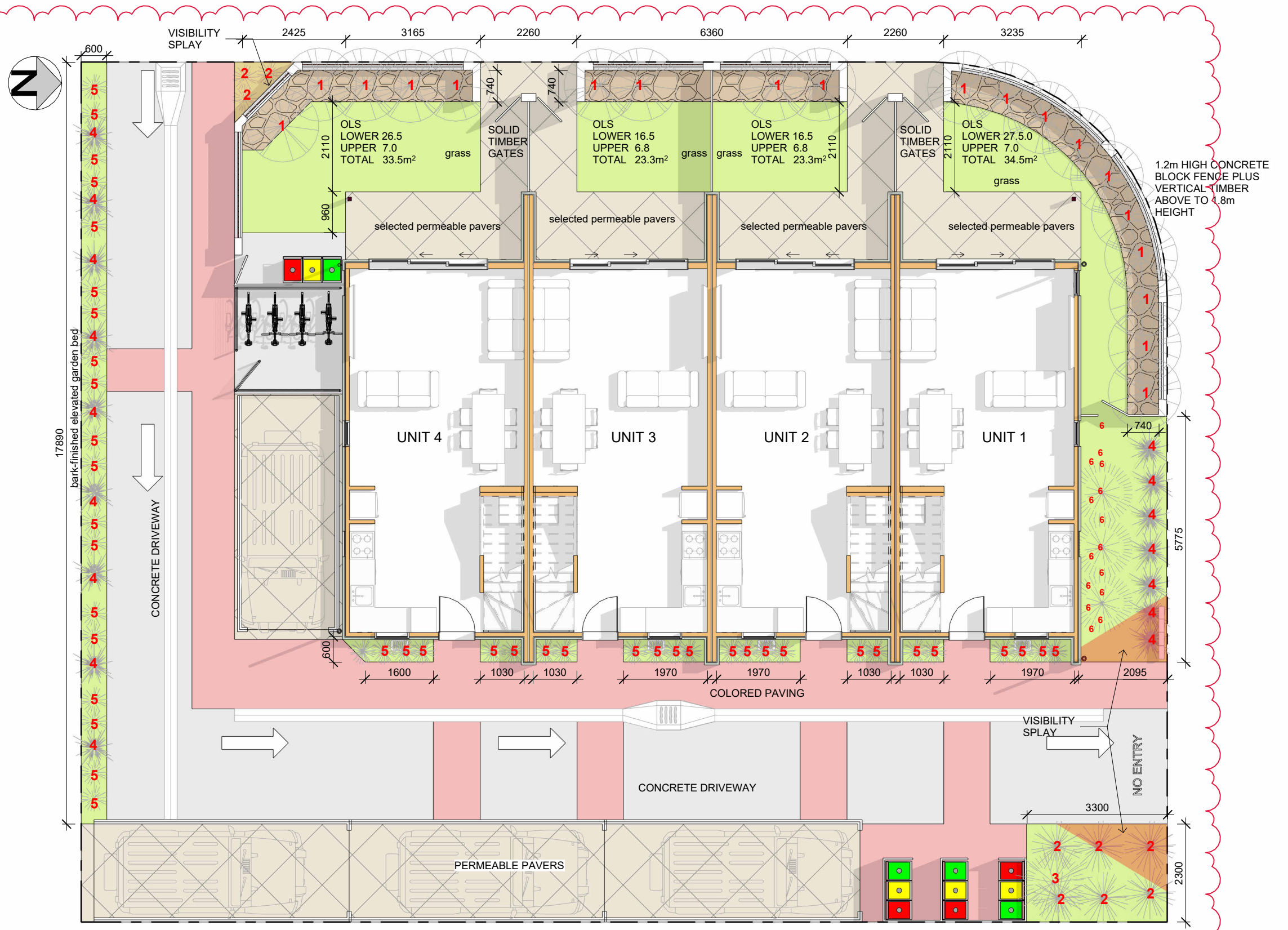

LIGHTING TO BE PROVIDED TO DWELLING ENTRANCE WAYS

CONTRASTING PAVEMENT - EITHER COLOURED EXPOSED AGGREGATE CONCRETE OR BRICK PAVERS

ALL CARPARK LANDSCAPED AREAS TO HAVE TIMBER EDGING LIGHTING TO BE PROVIDED TO DWELLING ENTRANCE WAYS

**SMC DESIGN STUDIO**  
ENGINEERS & ARCHITECTURE



**REVISION HISTORY**

A	19/10/2024	CLIENT CHANGES - BC RFI 1
---	------------	---------------------------

JOB TITLE:  
**MULTI-UNIT DEVELOPMENT**  
138 FITZGERALD AVE, CHRISTCHURCH  
CENTRAL, CHRISTCHURCH

DRAWING TITLE:  
**LANDSCAPING PLAN**

DATE:	23 OCTOBER 2024	SCALE:	1 : 100 @ A3
DRAWN BY:	NADER BERMUDEZ	SHEET No	A1.07
CHECKED BY:	DENIS CHERNYSHOV	REVISION:	A
APPROVED BY:	PAUL MILKIN		